



Autumn Newsletter 2011

Welcome back to existing families and a big welcome to all those families new to Clifford – we hope you have all settled in.

Autumn Events



We hope you enjoyed the **Autumn Family Picnic** – this was a chance for the children to get together too, not just the adults, and it was great to see such a good turnout on a fine autumn day.

Adults` Social Evening – We hope you enjoyed the night out in the pub. It is nice to get to know each other outside of the playground. The next adult-only community event will be a **quiz** on **Thursday 15 March 2012**. Further details to come.

Autumn Fundraisers

It was great to meet new faces and catch up at our **Meet and Greet Coffee Morning** after the first Best Work Assembly of term. We combined this with a **Macmillan Coffee Morning** and managed to raise **£138.52** for which Macmillan were very grateful – so thank you to all who were able to take part. The following day we had a CPA stall at **High Storrs Grand Opening** (Clifford is part of High Storrs “Family of Schools”) – we had a photo display showcasing School and CPA events and raised **£80.09** (yes a random 9p in there!) from further cake sales.

The refurbished/rebuilt school looked very impressive and the day was well supported. Both events couldn't have been so successful for us without our wonderful army of cake bakers, so thank you and please keep supporting us when you can!



From our **children`s artwork**, helped by CPA members and the TAs respectively, the **Christmas cards** have raised approx **£115** and the **tea towels and bags** a **£105**. The **Northbrook gift wrap** also raised **£100**, so some nice items should be on their way to you shortly. Thank you also for supporting the **Bonfire Bun Sale** which raised **£94.67**.

Upcoming Fundraising Events

The next big fundraising event we have coming up is “**Julefest**” - our Scandinavian Christmas Fayre - on **Sat 3 Dec** from **11am until 3pm** in School. Please mark your calendars and bring family and friends along. It is a fantastic event with stalls selling homemade foodstuffs and bespoke crafts, a café and lots of activities for the children. It will also be possible to visit Father Christmas, and watch some dancing round the Christmas tree, etc. It gets us in the Christmas mood and is also a chance to buy Christmas presents. Your support is greatly appreciated so we hope to see you there.

In the meantime we need loads of help with this event, either on the day or beforehand – please consider if you can volunteer in any way, however small – you can either sign up on the notice board lists of activities needed (also circulated in Best Work Assembly), catch us around school or email us at cpa@clifford.sheffield.sch.uk with any offers!

Before Julefest we have the **Children`s Autumn Disco** on **Thurs 24 Nov** – the children can party and practise their dance moves! Tickets are now on sale.

New Committee Members

We are really excited to welcome some new committee members: Marcus Crabbe (Peter Rec), Ali Hall (Carter Y2), Fiona Mearns (Jenna Y1), Jacqui Ross (Alexander & Imogen Rec) and Rachael Woodward (Oliver Y1). We have some mug shots on the website (<http://www.clifford.sheffield.sch.uk>) and notice boards if you're not sure who we all are. If you are interested in being part of the Committee you are very welcome: please see one of us or email cpa@clifford.sheffield.sch.uk We also welcome any ideas or suggestions you may have with regard to CPA activities.

Gift Aid and Matched Funding

The CPA is a registered charity. As such all personal donations made to the CPA can be increased by **21%** by completing a **gift aid** form. Whilst it may seem trivial to gift aid based on the price of a disco ticket, fayre entrance price, etc., these individual donations do truly add up and allow our contributions to the school to go further. So please take the time to complete/sign gift aid forms.

Also some companies do charity **matched funding** potentially doubling what we raise – please check with your employer if you could claim this for us.

Autumn Newsletter 2011

CPA Funding Plans for 2011-2012

Some of the committee met with Mrs Preston & Mr Rossiter early in the first term to get an idea of school funding projections and items or projects we could support. We normally raise about £3,000 per year and thought it might be nice to have a target to aim for. We would still like to support the regular events we have done in the past (e.g. Y2's Peak Adventure food, Easter Egg Cup painting and ice creams on the whole school summer trip) but also build up a fund for a bigger, more substantial project.

The School has had promised funding to build an enclosed **corridor link** from the main entrance, across the "internal playground" and through into the hall, withdrawn TWICE. This is very disappointing as it would link up all of the school rooms without having to go outside of the building or cut through Y2's classroom. School has obtained quotes for an interim measure to turn the middle hall window into an external door so you could get from the hall to the office etc. This will cost approx £4330 and although initially would involve a short uncovered walk outside, it could in time become a fully enclosed walkway, further funding permitting, and so ultimately be completed as originally planned. We think this is an excellent idea that would benefit school enormously. If you have any feelings either way about this suggestion please let us know. You can speak to a committee member or email us at cpa@clifford.sheffield.sch.uk. As an organisation we are trying to act in the School's, pupils' and parents' best interests and would like to give everyone the opportunity to have their say about all proposals.

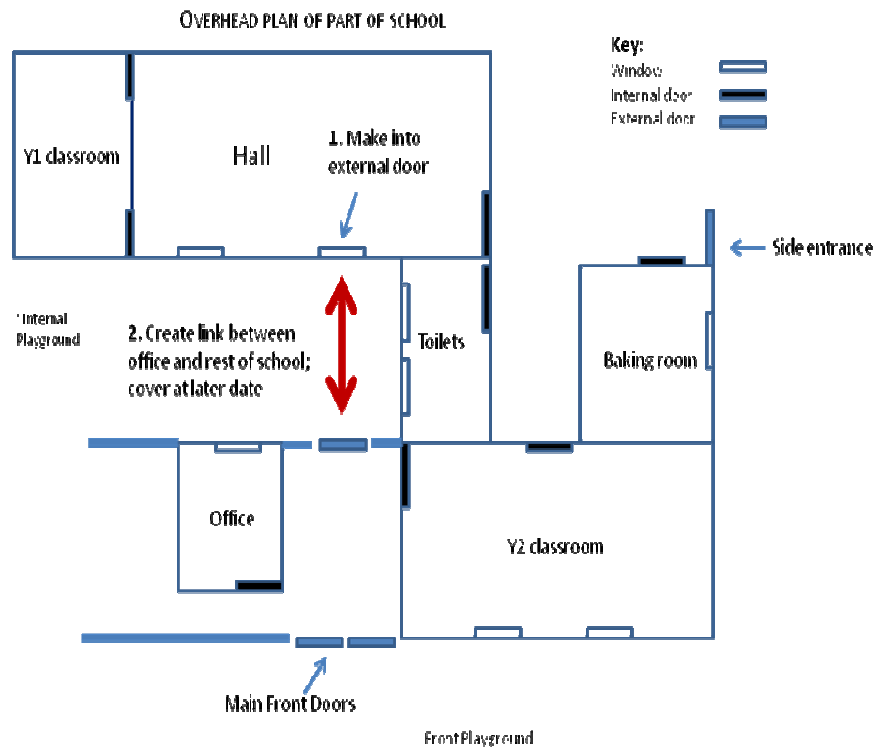

Other requests we are considering are making opening or additional **windows for Y2** as it gets very hot in their classroom, obtaining **mobile data devices** (e.g. iPod touches for film, animation & still image work, etc. – this is in consultation with our ICT Link Governor at Clifford), providing better **hand driers** in the children's main toilets, and replacing the wind up clock mechanism in the **Hall clock** with an electronic one (it would be lovely for this original fixture to work easily – we would love to hear from anyone with clock making skills or connections!)

Finally a Funding Acknowledgement

Clifford is a small school, this fact & the community spirit which this creates being one of its many strengths. We are very aware that we are constantly relying on the goodwill & generosity of a small total number of families for fundraising. We acknowledge money is less abundant all round, & ideally we as parents shouldn't have to pay for school equipment, but ultimately this doesn't help our children. Schools' budgets for work on premises, furniture and equipment have been cut across the city by some 60% which has a huge impact on the school's ability – a big difference we can all make to our children and the school is by supporting the CPA when and where we can. Our requests to you may sometimes seem unending, but we appreciate & do acknowledge all support we receive from you in return. Successful fundraising relies on **participation & ideas** – we welcome & thank you, for it all!

May we take this opportunity to wish you **an enjoyable end to the term** and a **lovely Christmas** and thank you for your continued support.